

# SPACE PLANS

## FINANCIAL

- Desks - 254
- Project Tables - 24
- Meeting Rooms - 9
- Quiet Rooms - 1
- Quiet Booths - 4
- Open Settings - 22
- Tea Points - 2
- Print Points - 3
- Server - 1
- Occupancy Ratio - 1:8 sq m

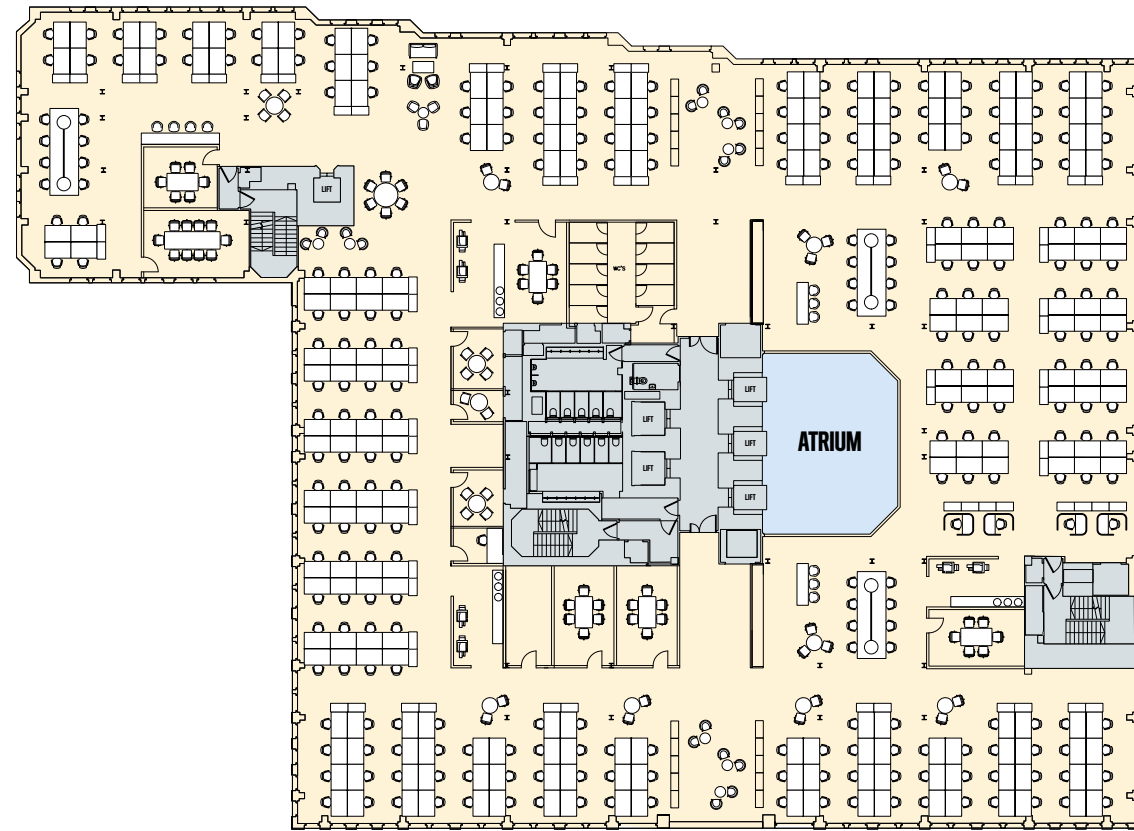

## CORPORATE

- Desks - 176
- Offices - 8
- Project Tables - 5
- Meeting Rooms - 9
- Quiet Rooms - 4
- Open Settings - 19
- Tea Points - 1
- Print Points - 4
- Server - 1
- Store - 1
- Occupancy Ratio - 1:10.7 sq m

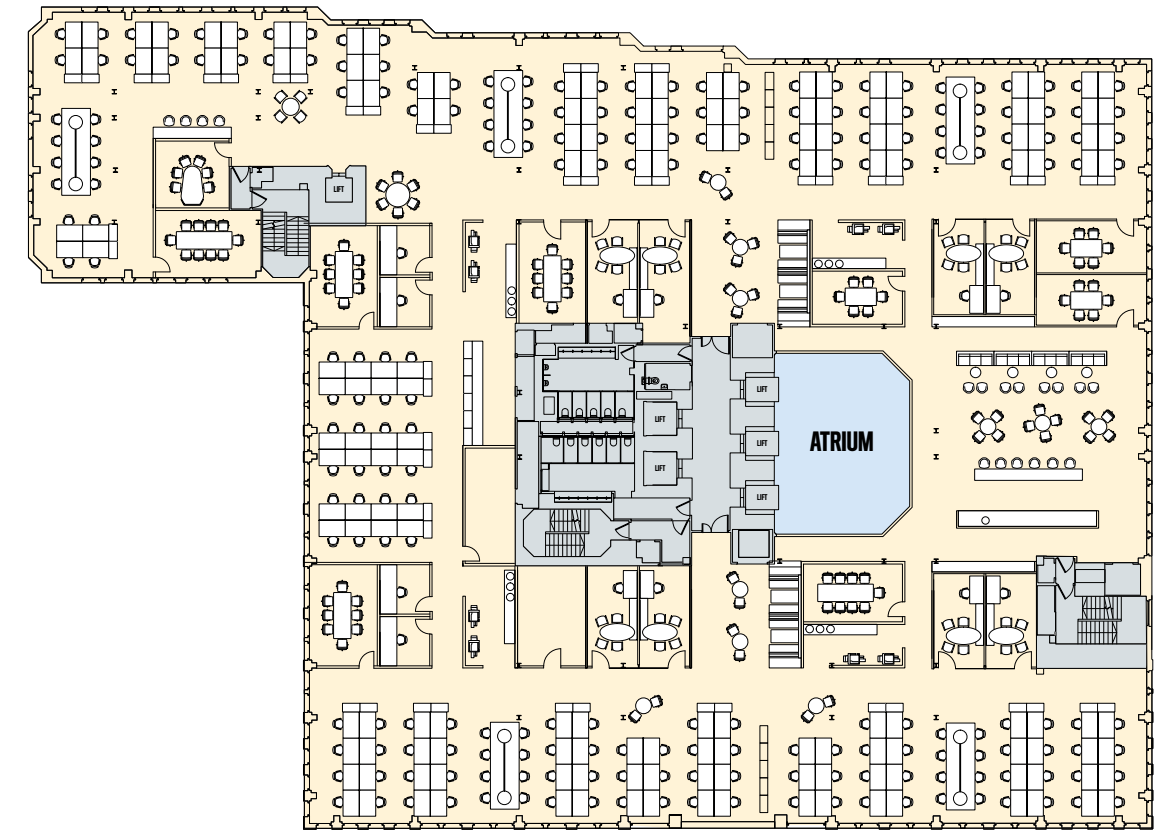

## LEGAL - CELLULAR

- Fee Earner Offices - 54/110 PPL
- Support Staff Desks - 26
- Meeting Rooms - 8
- Data Rooms - 2
- Open Settings - 4
- Tea Points - 2
- Print Points - 4
- Server - 1
- Store Room - 1
- Occupancy Ratio - 1:14.8 sq m



## MEDIA

- Desks - 220
- Meeting Rooms - 11
- Quiet Rooms - 5
- Open Settings - 19
- Tea Points - 2
- Print Points - 3
- Server - 1
- Occupancy Ratio - 1:9.3 sq m

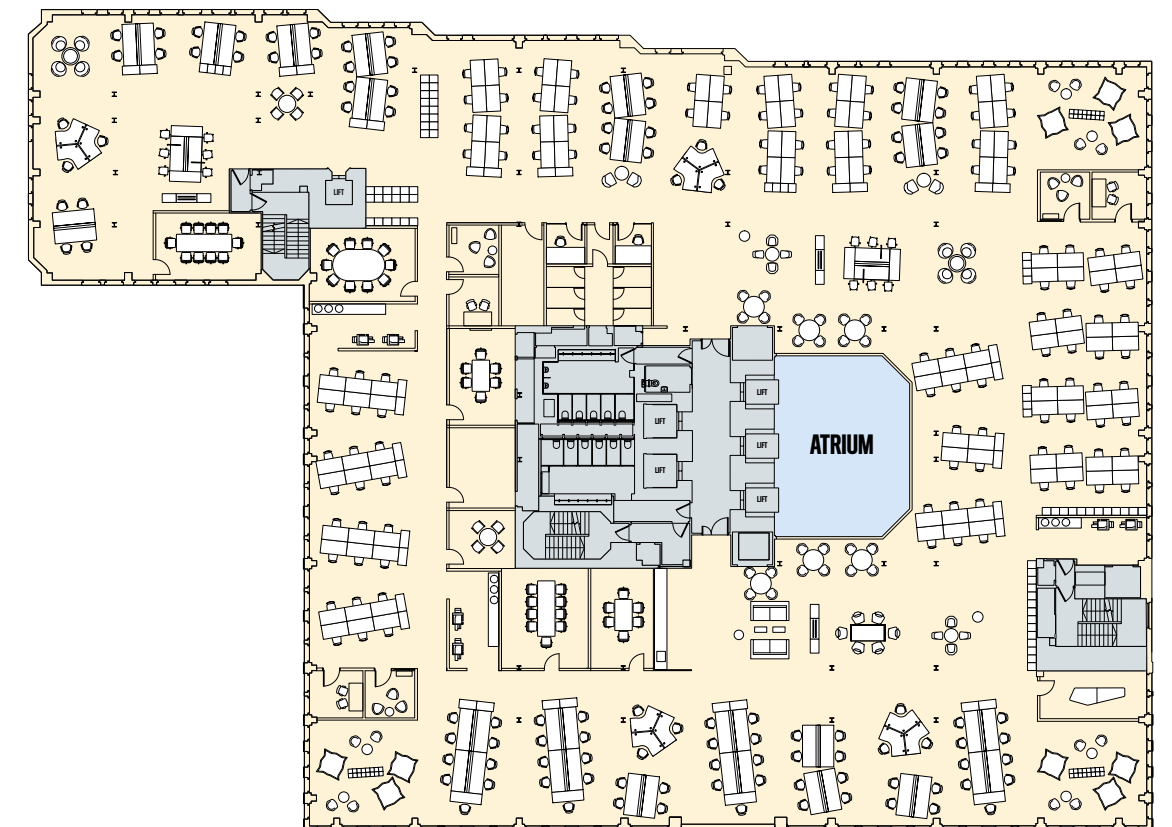

Space plans are for indicative purposes only and not to scale. Based on Level 3.